

AREA STATEMENT

TOTAL EXTENT	:	43560 SQ.FT.
ROAD AREA	:	11598 SQ.FT
PLOTTABLE AREA	:	31962 SQ.FT
SOLD OUT AREA	:	7048 SQ.FT
UNSOLD AREA	:	24914 SQ.FT
10% OF THE TOTAL AREA OF UN SOLD PLOTS REQUIRED FOR OSR	:	2491 SQ.FT
OSR PROVIDED	:	2505 SQ.FT
PLOT NO'S RESERVED FOR OSR 5,6,7 & 8	:	04 Nos.
SOLD PLOTS	:	05 Nos
UN SOLD PLOTS	:	24 Nos
TOTAL NO. OF PLOTS	:	33 Nos





NOTE:

1. A SPLAY AT THE INTERSECTION OF TWO OR MORE STREETS / ROADS SHALL BE PROVIDED AS PER DR 29.
2. ROAD AREA 11598 SQ.FT AND PARK AREA 2505 SQ.FT. TO BE GIFTED WIDE TO THE COMMISSIONER, KUNDRATHUR PANCHAYAT UNION VIDE GIFT DEED DOCUMENT NO. 549/ 2019 DATED 11.01.2019

CONDITIONS:

- 1) As per G.O.(ms).no.78 H & UD UD4 (3) department dt. 04.05.2017 and G.O. (Ms). No. 172 H & UD(UD4 (3) dept. dated. 13.10.2017 the individual plot to be regularised separately after approval of lay out framework subject to satisfaction of site dimensions / extent.
- 2)As per this Office Order No.15/2018 dated 12.12.2018 the regularisation of Layout Framework Approved.
- 3) Only those unapproved layouts where a part or full number of plots have been sold through a registered sale deed as on 20th October 2016 shall be Considered for regularization under these rules.
- 4) As per G.O.(Ms).No.172H & UD (UD4 (3) Dept dt. 13.10.2017 OSR charges are exempted for the plots sold on or before 20.10.2016.
- 5) Plots / Sub-divisions / Layouts shall be regularised under these rules only for "Residential Usage".

LEGEND

-  LAYOUT BOUNDARY
-  ROAD
-  PARK
-  SOLD PLOTS
-  UNSOLD PLOTS

P.P.D (Regularisation 2017) L.O	NO : 360 / 2019
APPROVED	
VIDE LETTER NO	: Reg.L / 13038 / 2017
DATE	: 14 / 02 / 2019
OFFICE COPY FOR SENIOR PLANNER CHENNAI METROPOLITAN DEVELOPMENT AUTHORITY	

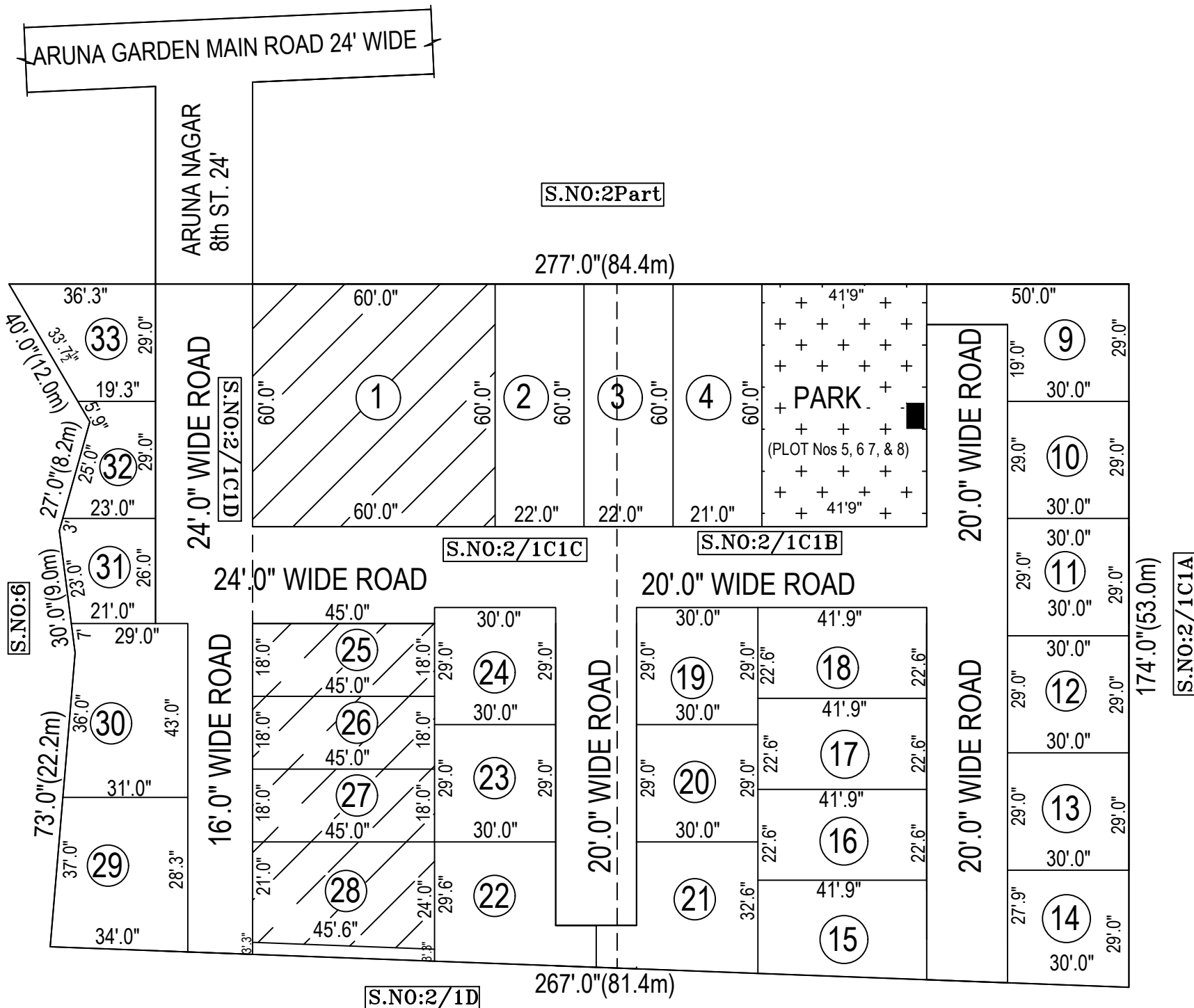

REGULARISATION OF LAYOUT FRAMEWORK IN S.No: 2/1C1B,2/1C1C & 2/1C1D AT CHIKKARAYAPURAM VILLAG OF KUNDRATHUR PANCHAYAT UNION AS PER G.O.(Ms) No:78 H&UD UD4 (3) DEPT. DT:04.05.2017 AND G.O.(Ms) No:172 H&UD UD4 (3) DEPT. DT:13.10.2017

SCALE : 1" = 66' (ALL MEASUREMENTS ARE IN FEET)

