

AREA STATEMENT

TOTAL EXTENT (AS PER FRAME WORK)	:	13658 Sq.M
ROAD AREA	:	3721 Sq.M
PLOTTABLE AREA	:	9937 Sq.M
TOTAL NO. OF PLOTS	:	81

NOTE:

- 1) A SPLAY AT THE INTERSECTION OF TWO OR MORE STREETS / ROADS SHALL BE PROVIDED AS PER DR 29.
- 2) THE GREATER CHENNAI CORPORATION TO ENSURE THAT ALL THE ROADS ARE VESTED WITH THEM.

CONDITIONS:

- 1) As per G.O.(ms).no.78 h & ud ud4 (3) department dt. 04.05.2017 and G.O. (Ms). No. 172 H & UD(UD4 (3) dept. dated. 13.10.2017 the individual plots to be regularised separately after approval of lay out framework, subject to satisfaction of site dimensions / Extent.
- 2) only those unapproved layouts where in a part or full number of plots have been sold through a registered sale deed as on 20 th October 2016 shall be Considered for regularization under these rules.
- 3) As per G.O.(Ms).No:172 H & UD (UD4 (3) Dept dt.13.10.2017 OSR charges are exempted for the plots sold on or before 20.10.2016.

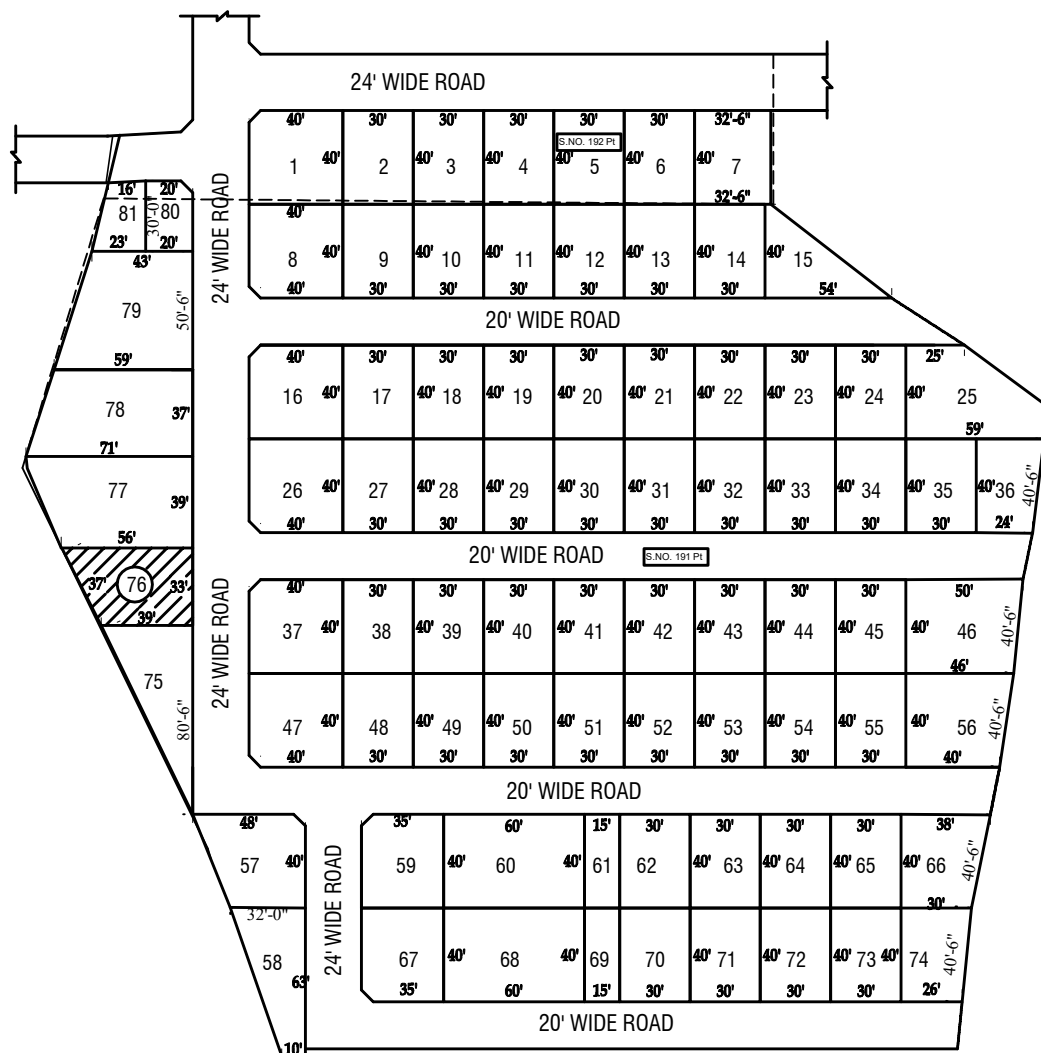

LEGEND

- LAYOUT BOUNDARY
- ROAD
- EXG. ROAD

IN PRINCIPLE APPROVAL OF LAYOUT FRAMEWORK IN S.NOS : 191Pt., & 192 Pt., AT JALLADAIYANPETAI VILLAGE OF GREATER CHENNAI CORPORATION. AS PER G.O.(Ms).No.78 H & UD UD4 (3) DEPARTMENT DT. 4.05.2017. AND G.O.(Ms).No.172 H & UD UD4 (3) DEPARTMENT DT. 13.10.2017.

SCALE : 1:66' (ALL MEASUREMENTS ARE IN FEET)

P.P.D
L.O (Regularisation 2017) NO : 13
2018

APPROVED

VIDE LETTER NO : Reg.L/2005/2018

DATE : / / 2018

OFFICE COPY
FOR MEMBER SECRETARY
CHENNAI METROPOLITAN
DEVELOPMENT AUTHORITY

