

**NOTE:**

- 1) A SPLAY AT THE INTERSECTION OF TWO OR MORE STREETS / ROADS AND STREET ALIGNMENTS BE PROVIDED AS PER THE DEVELOPMENT REGULATIONS OF CMA.
- 2) SHOLAVARAM PANCHAYAT UNION TO ENSURE THAT ALL THE ROADS ARE VESTED WITH THEM AS PER THE GOVERNMENT ORDERS

**CONDITIONS:**

- 1) As per G.O.(ms) no 78 h & ud ud4 (3) department dt. 04.05.2017 and G.O. (Ms). No. 172 H & UD/UD4 (3) dept. dated. 13.10.2017 the individual plots to be regularized separately after approval of lay out framework subject to adhering the conditions stipulated in the Government Orders.
- 2) Only those unapproved layouts where in a part or full number of plots have been sold through a registered sale deed as on 20th October 2016 shall be Considered for regularization under these rules.
- 3) As per G.O.(Ms).No.172 H & UD (UD4 (3) Dept dt.13.10.2017 OSR charges are exempted for the plots sold on or before 20.10.2016.
- 4) As per this Office No.15/2018 dt.12.12.2018 the In-Principle Layout Framework approved. In-principle approval for the layout frame work for regularizing individual plots may be considered only with reference to connectivity of layout to the public road and internal road pattern
- 5) Plot or Layout in part or whole, which is located in Public water body like channel / canal etc., shall not be eligible for regularization.
- 6) The Local Body shall regularise the individual plot by considering the least extent of ownership documents i.e., patta & sale deed document.
- 7) Plots/Sub-Divisions/Layouts shall be regularized under these rules only for Residential usage.
- 8) As per Second Master Plan for Chennai Metropolitan Area the Street alignment of G.N.T. Bye-Pass Road is 61.0Mt. Above street alignment will be provided by the individual plot owners under the provision of Second Master Plan.
- 9) S.No-620 of Sholavaram Village is close to water body, Hence The Local body has to obtain NOC from PWD on inundation point of view and NOC from Tahsildar concerned, the layout is not obstructing the waterways on the common fields irrigation on the ground, before regularization of individual plots in the layout under reference.

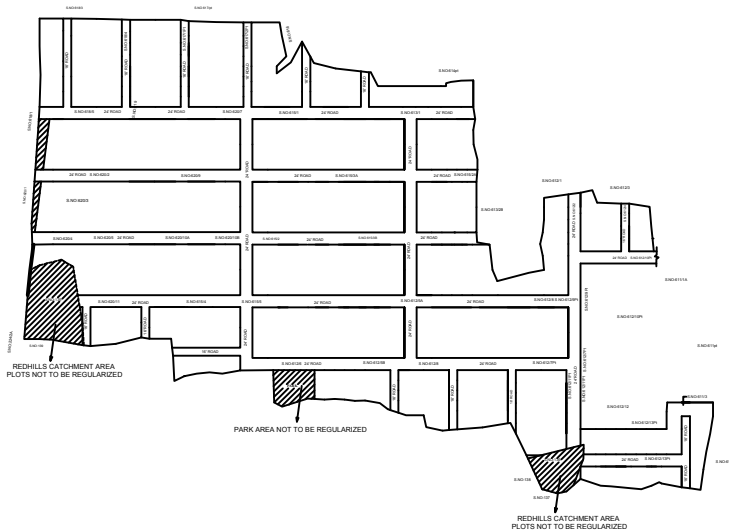

**LEGEND**

- LAYOUT BOUNDARY
- ROAD
- EXG ROAD
- PLOTS NOT TO BE REGULARIZED

**P.P.D** (Regularization NO : 1104  
**L.O** 2017)

**APPROVED**

VIDE LETTERNO : Reg.L /5590/2019

DATE : /04/2019

**OFFICE COPY**

FOR SENIOR PLANNER  
 CHENNAI METROPOLITAN  
 DEVELOPMENT AUTHORITY

IN-PRINCIPLE APPROVAL OF LAYOUT FRAMEWORK IN S.No:611/3, 612/2,4,5A,5B,6,7Pt,8,9Pt,10Pt,11Pt,13Pt, 613/1,2A,3, 615/1,2,3A,3B,4,5,6, 617/1pt,2pt, 618/4,5, 619, 620/2,3,4,5,6,7,8,9,10A,10B,11 AT SHOLAVARAM VILLAGE OF SHOLAVARAM PANCHAYAT UNION AS PER G.O.(Ms) No:78 H&UD UD4 (3) DEPT. DT:04.05.2017 AND G.O.(Ms) No:172 H&UD UD4 (3) DEPT. DT:13.10.2017 AND OFFICE ORDER NO.15/2018 DT: 12.12.2018.

SCALE: 1" = 66' (ALL MEASUREMENTS ARE IN FEET)

