

NOTE:

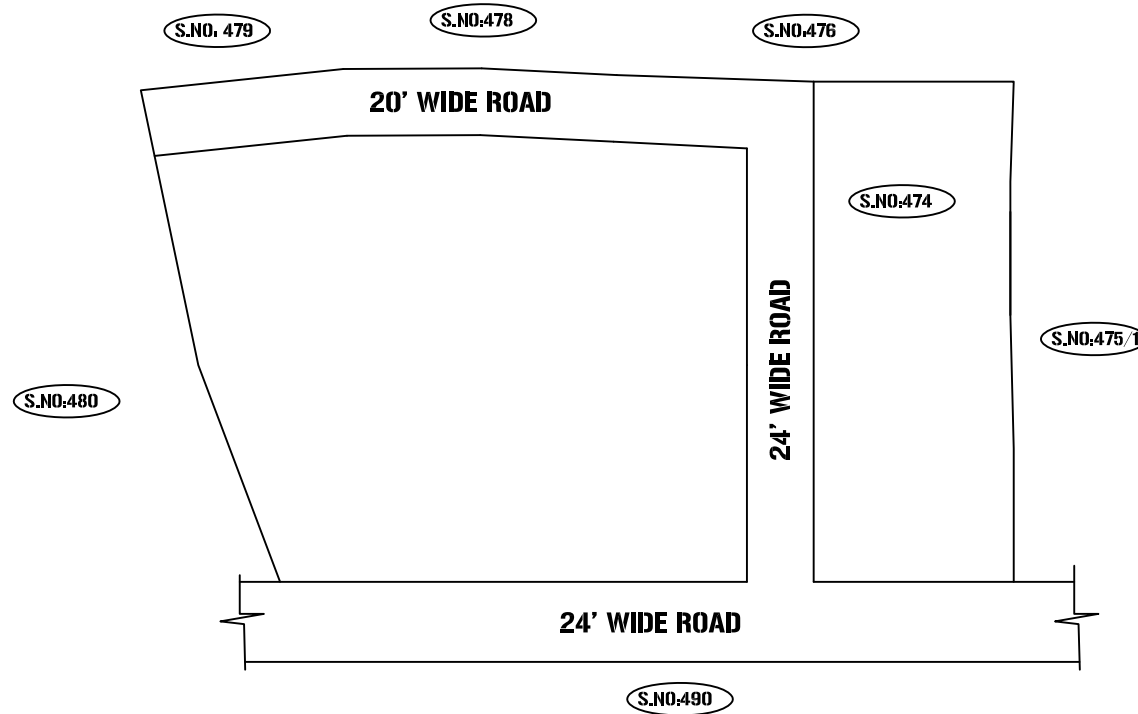

- 1) A SPLAY AT THE INTERSECTION OF TWO OR MORE STREETS / ROADS AND STREET ALIGNMENTS BE PROVIDED AS PER THE DEVELOPMENT REGULATIONS OF CMA.
- 2) THIRUVERKADU MUNICIPALITY TO ENSURE THAT ALL THE ROADS ARE VESTED WITH THEM AS PER THE GOVERNMENT ORDERS.

CONDITIONS:

- 1) As per G.O.(ms).no.78 h & ud ud4 (3) department dt. 04.05.2017 and G.O. (Ms). No. 172 H & UD(UD4 (3) dept. dated. 13.10.2017 the individual plots to be regularized separately after approval of lay out framework subject to satisfaction of site dimension / extent.
- 2) Only those unapproved layouts where in a part or full number of plots have been sold through a registered sale deed as on 20th October 2016 shall be Considered for regularization under these rules.
- 3) As per G.O.(Ms).No:172 H & UD (UD4 (3) Dept dt.13.10.2017 OSR charges are exempted for the plots sold on or before 20.10.2016.
- 4) Plot or Layout in part or whole, which is located in Public water body like channel / canal etc.,shall not be eligible for regularization.
- 5) The Local Body shall regularise the individual plot by considering the least extent of ownership documents i.e., patta & sale deed document.
- 6) Before regularization of individual plots in the layout under reference the Local Body has to obtain a certificate or status report from the Tahsildar of the concerned taluk that, the layout is not obstructing the water ways on the common fields irrigation channels on the ground and flood level or inundation status.



LEGEND

-  LAYOUT BOUNDARY
-  ROAD
-  EXG. ROAD

P.P.D (Regularization NO : 1073
L.O 2017) 2018

APPROVED

VIDE LETTER NO : Reg.L /10707/ 2018

DATE : /06/ 2018

OFFICE COPY

FOR MEMBER SECRETARY
CHENNAI METROPOLITAN
DEVELOPMENT AUTHORITY

IN-PRINCIPLE APPROVAL OF LAYOUT FRAMEWORK IN S.No:474/1 & 475/1 AT AYANAMBAKKAM VILLAGE OF THIRUVERKADU MUNICIPLALITY AS PER G.O.(Ms) No:78 H&UD UD4 (3) DEPT. DT:04.05.2017 AND G.O.(Ms) No:172 H&UD UD4 (3) DEPT. DT:13.10.2017

SCALE : 1" = 66' (ALL MEASUREMENTS ARE IN FEET)

