

AREA STATEMENT

TOTAL EXTENT : 200302 Sq.ft.
(as per frame work Dwg.)

ROAD AREA : 44301 Sq.ft.

PLOTTABLE AREA : 156001 Sq.ft.

TOTAL NO. OF PLOTS : 80 Nos.



NOTE:

GREATER CHENNAI CORPORATION TO ENSURE THAT ALL THE ROADS ARE VESTED WITH THEM

CONDITIONS:

- 1) As per G.O.(ms).no.78 h & ud ud4 (3) department dt. 04.05.2017 and G.O. (Ms). No. 172 H & UD(UD4 (3) dept. dated. 13.10.2017the individual plots to be regularised separately after approval of lay out framework
- 2) only those unapproved layouts where in a part or full number of plots have been sold through a registered sale deed as on 20 th October 2016 shall be Considered for regularization under these rules. Greater Chennai Corporation should ensure the same in this Layout.
- 3) As per G.O.(Ms).No:172 H & UD (UD4 (3) Dept dt.13.10.2017 OSR charges are exempted for the plots sold on or before 20.10.2016

LEGEND

-  LAYOUT BOUNDARY
-  ROAD

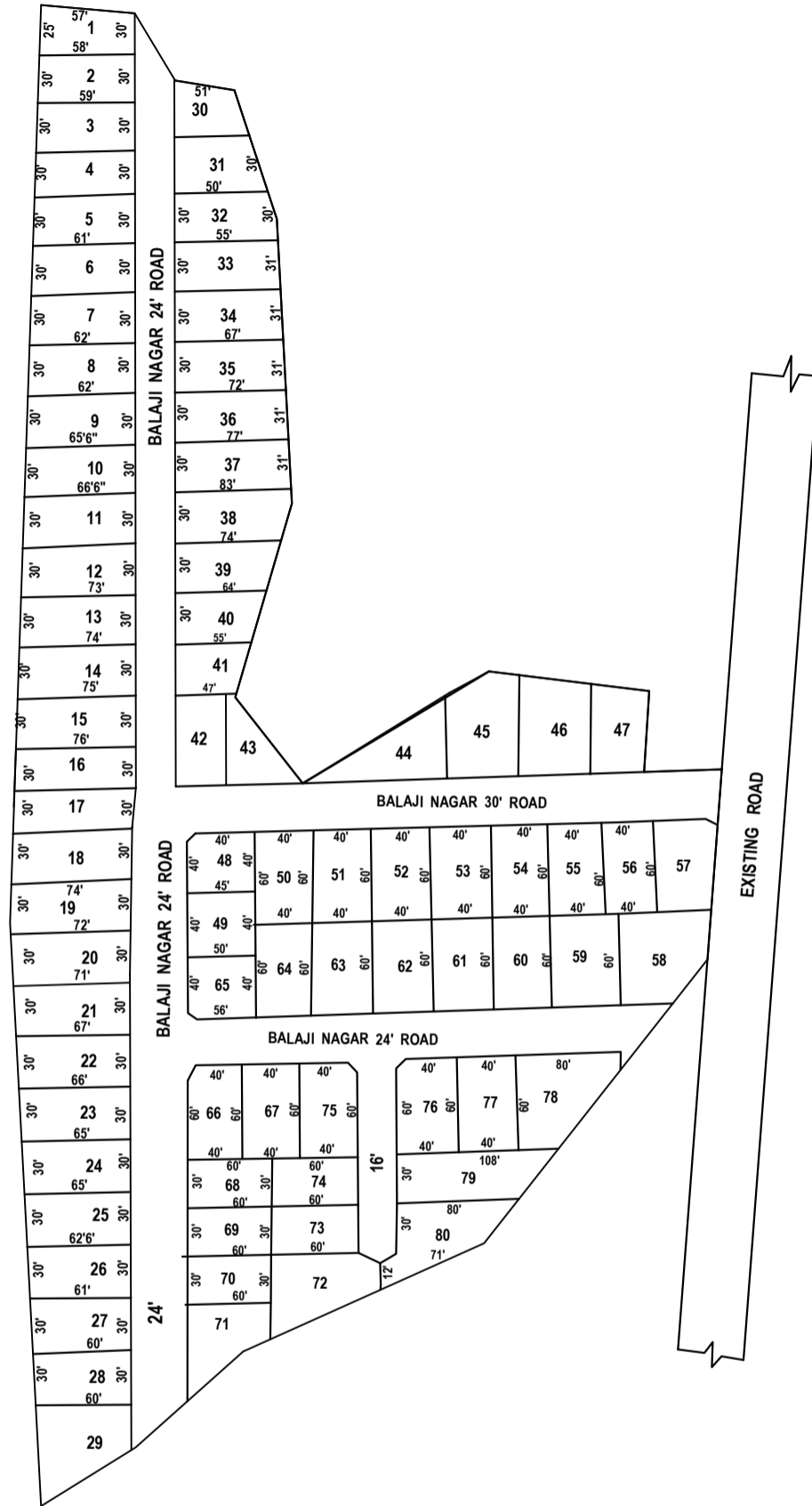

**IN-PRINCIPLE APPROVAL OF LAYOUT FRAMEWORK IN
S.NO: 226 AT PADI VILLAGE OF GREATER CHENNAI
CORPORATION AS PER G.O.(Ms) No:78 H&UD UD4 (3) DEPT.
DT:04.05.2017 AND G.O.(Ms) No:172 H&UD UD4 (3) DEPT.
DT:13.10.2017**

SCALE : 1" = 66' (ALL MEASUREMENTS ARE IN FEET)

P.P.D (Regularisation NO : 03
L.O 2017) 2018

APPROVED
VIDE LETTER NO : Reg.L / 1970 / 2018
DATE : / 02 / 2018

OFFICE COPY

MEMBER SECRETARY
CHENNAI METROPOLITAN
DEVELOPMENT AUTHORITY

