

SITE EXTENT (AS PER DOCUMENT) = 3468 Sq.M
ROAD AREA = 862 Sq.M
NO. OF PLOTS = 8 Nos.

NOTE:

1. SPLAY - 1.5M x 1.5M
2. MEASUREMENTS ARE INDICATED EXCLUDING SPLAY DIMENSIONS
3. ROAD AREA WAS HANDED OVER TO THE LOCAL BODY VIDE GIFT DEED
 DOC. NO. 2629 / 2022, DATED: 08.03.2022 @ SRO, PALLAVARAM

CONDITIONS :

(1) TNCDBR-2019, RULE NO:47 (11) :

THE COST OF LAYING IMPROVEMENTS TO THE SYSTEMS IN RESPECT OF ROAD, WATER SUPPLY, SEWERAGE, DRAINAGE OR ELECTRIC POWER SUPPLY THAT MAY BE REQUIRED AS ASSESSED BY THE CONCERNED AUTHORITY, NAMELY, THE LOCAL BODY AND TAMIL NADU ELECTRICITY BOARD, SHALL BE BORNE BY THE APPLICANT.

(2) SUBJECT TO THE CONDITION "THE CULVERT DESIGNS SHALL BE OBTAINED FROM HIGHWAYS DEPARTMENT AND EXECUTE THE SAME FOR ACCESSING THE ROAD AS PER GUIDELINE ISSUED BY THE HIGHWAYS DEPARTMENT BEFORE ISSUE OF COMPLETION CERTIFICATE"

(3) LOCAL BODY SHOULD ENSURE RECEIPT OF PWD REMARKS AND THE COMPLIANCE OF CONDITIONS MENTION THERE IN THE LETTER BEFORE SANCTIONING AND RELEASE OF THE SUB-DIVISION.

© NECESSARY SPACE FOR BUILDING LINE TO BE LEFT AS PER THE RULE IN FORCE WHILE TAKING UP DEVELOPMENT IN EVERY PLOT.

LEGEND:

- SITE BOUNDARY
- ROAD GIFTED TO LOCAL BODY
- EXISTING ROAD

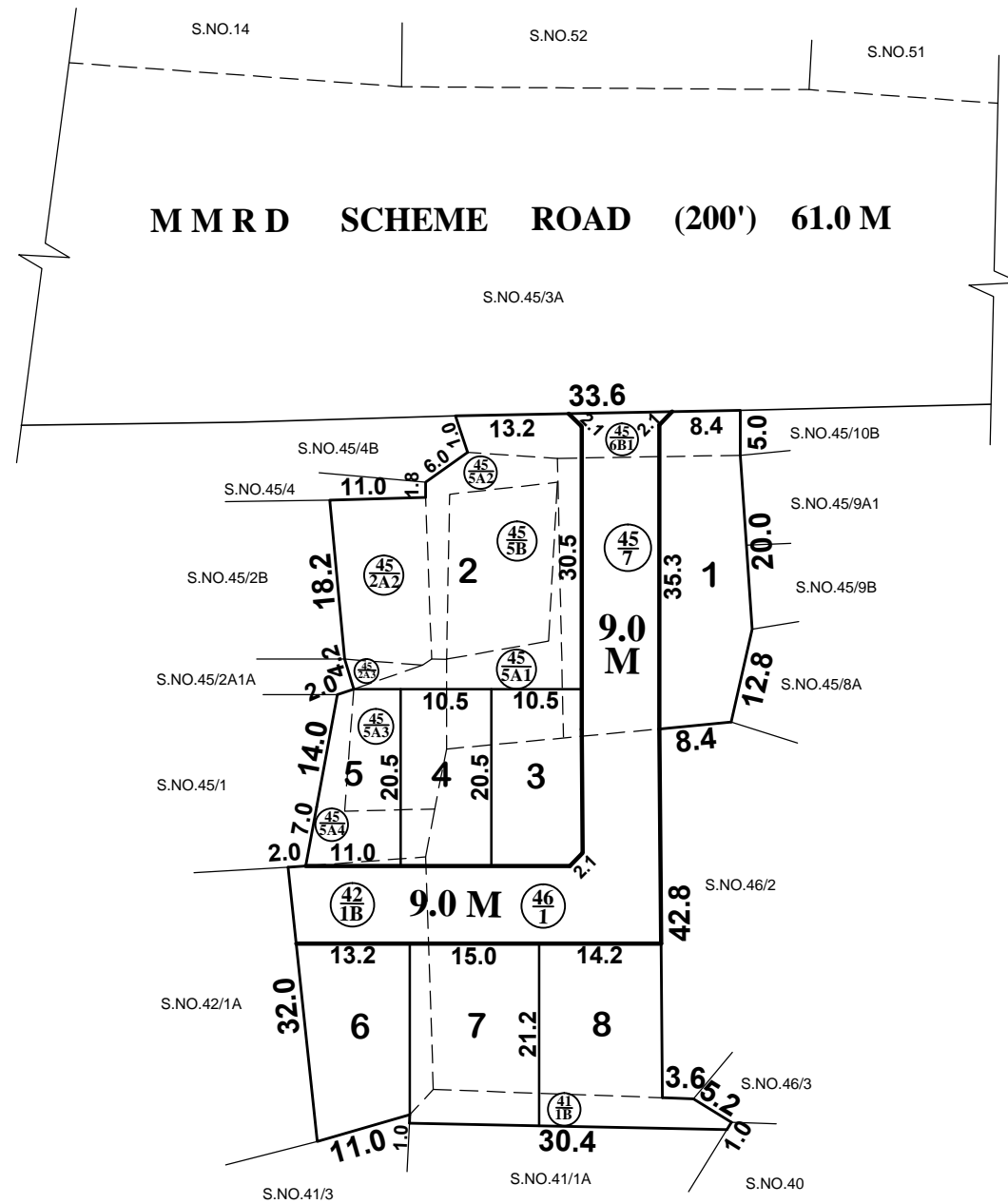

CONDITIONS:

THE SUB-DIVISION APPROVED IS VALID SUBJECT TO OBTAINING SANCTION FROM THE LOCAL BODY CONCERNED.

P.P.D NO : **37**
L.O **2022**

APPROVED

VIDE LETTER NO : LAYOUT-1 / 0222 / 2021

DATE : 31 / 03 / 2022

OFFICE COPY

**FOR SENIOR PLANNER (LAYOUT)
 CHENNAI METROPOLITAN
 DEVELOPMENT AUTHORITY**

This Planning Permission Issued under New Rule TNCDBR.2019 is subject to final outcome of the W.P(MD) No.8948 of 2019 and WMP (MD) Nos. 6912 & 6913 of 2019.

ST.THOMAS MOUNT PANCHAYAT UNION

SUB-DIVISION OF HOUSE SITES IN S.No:41/1B, 42/1B, 45/2A2, 2A3, 5A1, 5A2, 5A3, 5A4, 5B, 6B1, 7 AND 46/1 OF KOVILAMBAKKAM VILLAGE.

SCALE : 1:800 (ALL MEASUREMENTS ARE IN METRE.)

