

TOTAL EXTENT (AS PER DOCUMENT) = 9915 Sq.M
ROAD AREA = 2225 Sq.M
TOTAL No. OF PLOTS = 32 Nos.
OWNER'S USE (2477 Sq.m) = 1 No.

NOTE:



1. SPLAY - 3.0M x 3.0M, 1.5M x 1.5M
2. MEASUREMENTS ARE INDICATED EXCLUDING SPLAY DIMENSIONS
3.  ROAD AREA WAS ALREADY HANDED OVER TO THE LOCAL BODY
VIDE GIFT DEED DOC. NO. 5833 / 2014, DATED : 12/05/2014

CONDITION :

DR RULE NO: 29 (11)

THE COST OF LAYING IMPROVEMENTS TO THE SYSTEMS INRESPECT OF ROAD, WATER SUPPLY, SEWERAGE, DRAINAGE OR ELECTRIC POWER SUPPLY THAT MAY BE REQUIRED AS ASSESSED BY THE COMPETENT AUTHORITY, SHALL BE BORNE BY THE APPLICANT.

LEGEND:

-  SITE BOUNDARY
-  PROPOSED ROAD
-  EXISTING ROAD

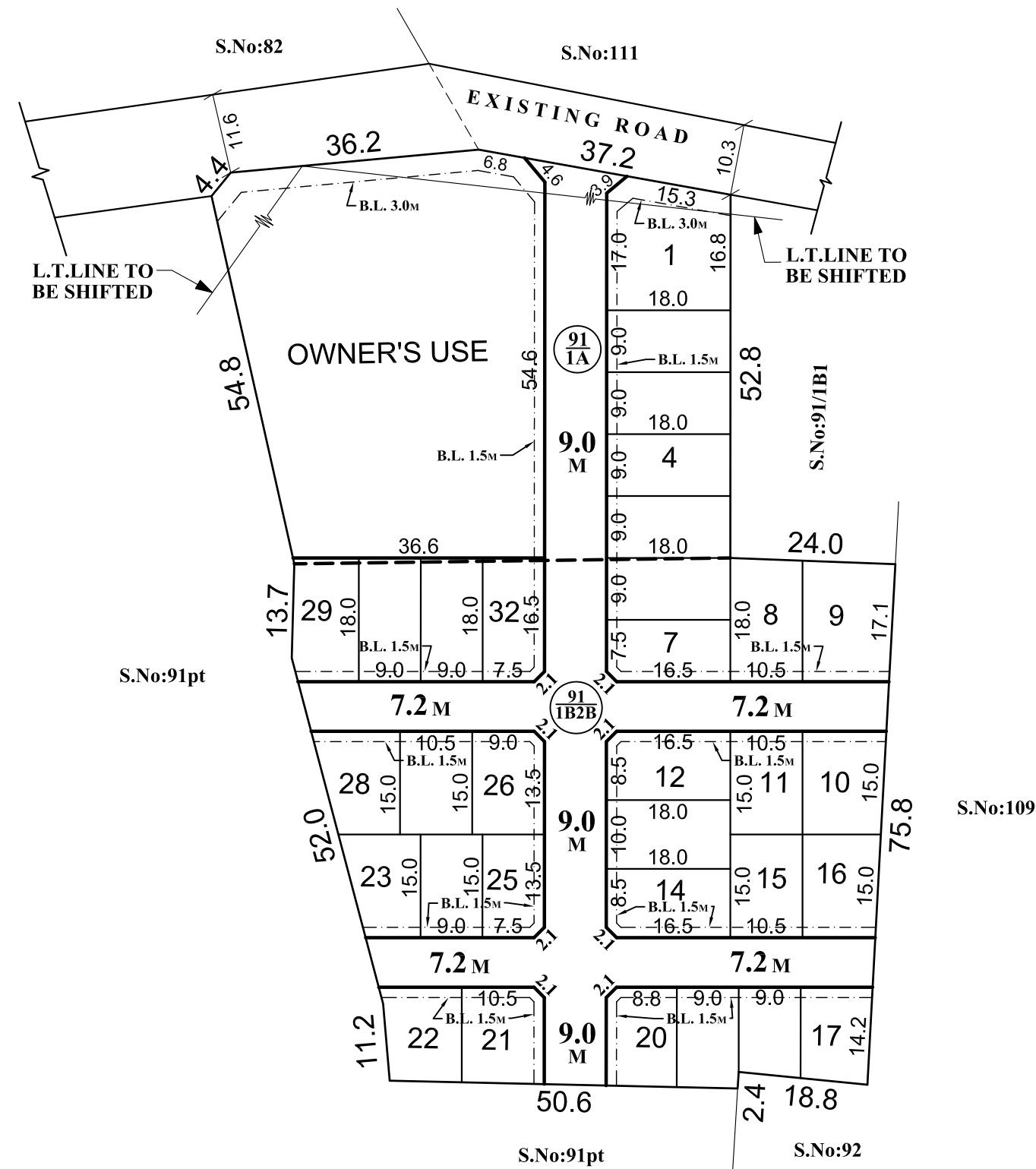

CONDITIONS:

THE LAYOUT APPROVED IS VALID SUBJECT TO OBTAINING SANCTION FROM THE LOCAL BODY CONCERNED.

P.P.D NO: 18
L.O 2014

APPROVED

VIDE LETTER NO : L1 / 8865 / 2013
 DATE : 17 / 06 / 2014

OFFICE COPY

FOR MEMBER SECRETARY
 CHENNAI METROPOLITAN
 DEVELOPMENT AUTHORITY



POONAMALLEE PANCHAYAT UNION
LAYOUT OF HOUSE SITES IN S.No: 91/1A & 1B2B OF SORANCHERI VILLAGE.

SCALE : 1:800 (ALL MEASUREMENTS ARE IN METRE.)