

TOTAL EXTENT : 4922 M2
ROAD AREA : 877 M2
NO OF PLOTS : 24 NOS

NOTE:

1. SPLAY 3.0M X 3.0M
2. MEASUREMENTS ARE INDICATED EXCLUDING SPLAY DIMENSIONS.
3. ROAD AREA WAS ALREADY HANDED OVER TO THE LOCAL BODY.

VIDE GIFT DEED DOCUMENT NO: 349 / 2011. DATED.17.2.2011.

CONDITIONS:-

1.DR. RULE NO:29(11)

THE COST OF LAYING IMPROVEMENTS TO THE SYSTEMS IN RESPECT OF ROAD,WATER SUPPLY , SEWERAGE,DRAINAGE OR ELECTRIC POWER SUPPLY THAT MAY BE REQUIRED AS ASSESSED BY THE COMPETENT AUTHORITY SHALL BE BORNE BY THE APPLICANT.

2.THE PROPOSED BUILDINGS ARE PERMISSABLE IN THE LAYOUT OF HOUSE SITES AS PER THE PROVISIONS OF THE DEVELOPMENT REGULATIONS UNLESS AND OTHERWISE SPECIFICALLY MENTIONED.

CONDITION:-

THE LAYOUT APPROVAL IS VALID SUBJECT TO OBTAINING SANCTION FROM THE LOCAL BODY CONCERNED

- LEGEND**
- SITE BOUNDARY
 - PROPOSED ROAD
 - EXISTING ROAD

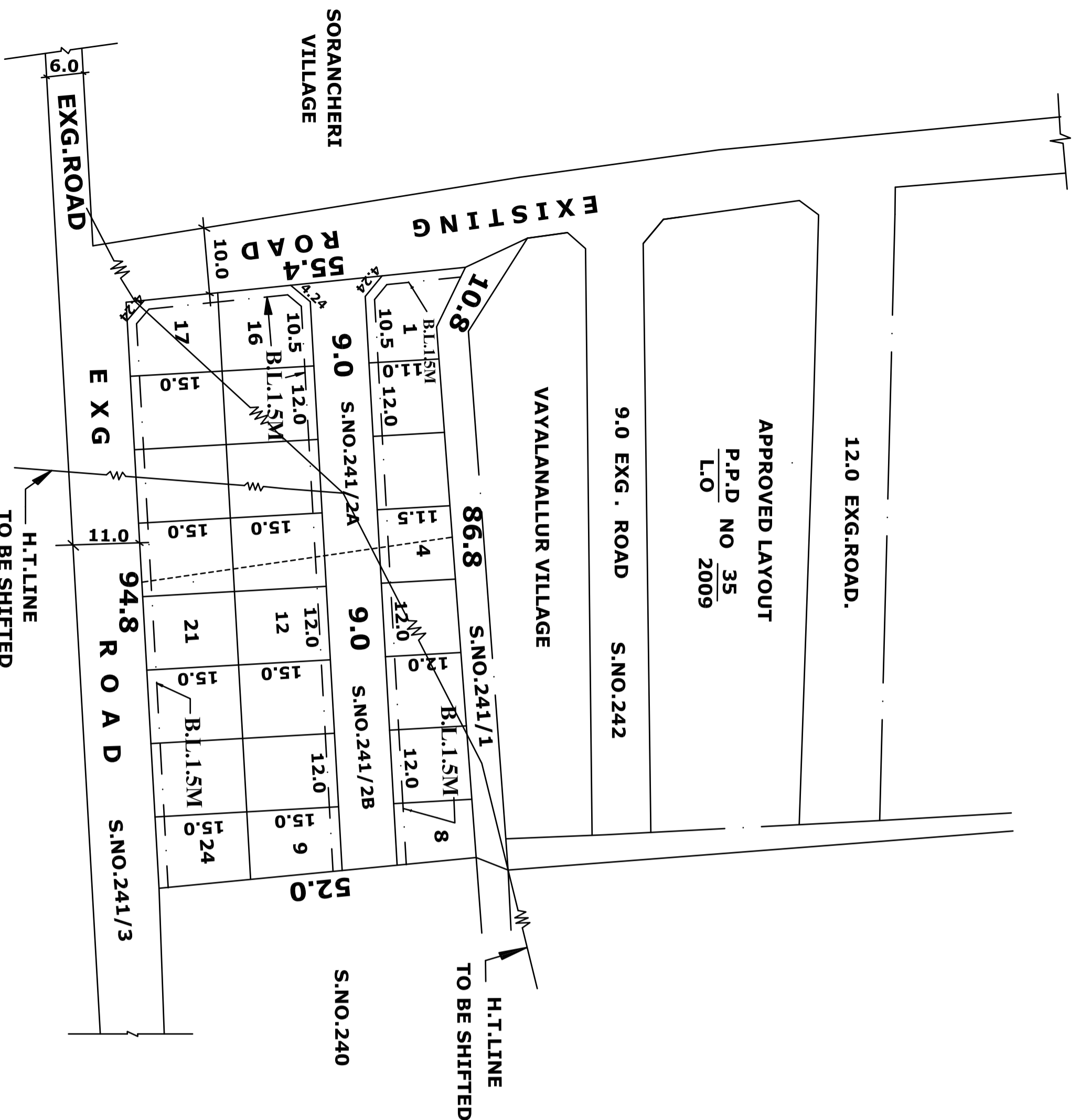

POONAMALLEE PANCHAYAT UNION

LAYOUT OF HOUSE SITES IN S.NO: 241/2A AND 241/2B OF VAYALANALLUR VILLAGE.

SCALE 1: 800 (ALL MEASUREMENTS ARE IN METRE)

OFFICE COPY

FOR MEMBER SECRETARY
 CHENNAI METROPOLITAN
 DEVELOPMENT AUTHORITY

P.P.D NO 13
L.O APPROVED 2011
 VIDE LETTER NO : L1 / 2980 / 2011
 DATED : 15 / 06 / 2011

