

TOTAL EXTENT : 4799 SQ.M
ROAD AREA : 1681 SQ.M
TOTAL NO. OF PLOTS : 20 NOS.
SEWAGE TREATMENT PLANTS & RECYCLING PLANT : 1 NOS.

NOTE:

1. SPLAY 1.5M X 1.5M, 3.0M X 3.0M.
2. MEASUREMENTS INDICATED ARE EXCLUDING SPLAY DIMENSIONS.
3. ROAD AREA WAS ALREADY HANDED OVER TO THE LOCAL BODY VIDE GIFT DEED DOC. NO: 5450 / 2010 , DT: 21 / 05 / 2010.

CONDITIONS:

1. DR RULE NO: 29 (II)

THE COST OF LAYING IMPROVEMENTS TO THE SYSTEMS IN RESPECT OF ROAD, WATER SUPPLY, SEWERAGE, DRAINAGE OR ELECTRIC POWER SUPPLY THAT MAY BE REQUIRED AS ASSESSED BY THE COMPETENT AUTHORITY, SHALL BE BORNE BY THE APPLICANT.

PWD CONDITIONS:

THE FOLLOWING CONDITIONS OF PWD, STIPULATED IN CHIEF ENGINEER, P.W.D. WARD, CHENNAI REGION, CHEPPAK, CHENNAI-5, LETTER NO: TSD/05/99/2009, DT: 26-08-2009, ARE TO BE COMPLIED BY THE APPLICANT WHILE FORMATION OF THE LAYOUT.

1. THE FIELD LEVELS OF THE PROMOTER'S LAND INDICATE THAT THE SITE IS SAFE AGAINST THE INUNDATION AND THERE IS NO POSSIBILITY OF INUNDATION IN THE AREA.
2. THE PROMOTER SHOULD NOT DEVELOP ANY STRUCTURE WITHIN THE 2000M FROM CHANNEL BOUNDARY STONE.
3. THE PROMOTER MAY BE PERMITTED TO CONSTRUCT THE RCC BOX CULVERT ACROSS THE CHANNEL AT S.NO. 1181 BY WATER RESOURCES DEPARTMENT AS DEPOSIT WORK TO DEVELOP THE LAND AS PER CM&A RULES, IF NECESSARY.
4. THE WIDTH OF THE FIELD CHANNEL EARMARKED IN THE SKETCH SHOULD BE MAINTAINED AS PER REVENUE RECORDS.
5. THE PROMOTER SHOULD NOT BE ANY HINDRANCE TO THE FREE FLOW OF WATER THROUGH THE EXISTING CHANNEL TO THE DOWN SIDE AVACUIT.
6. THE IRRIGATION CHANNEL SHOULD BE WELL PRESERVED BY THE PROMOTER WITHOUT ANY OBSTRUCTIONS TO FACILITATE IRRIGATION TO THE DOWN SIDE AVACUIT.
7. THE PROMOTER SHOULD NOT CONSTRUCT ANY OTHER CROSS MASONRY STRUCTURES ACROSS THE CHANNEL WITHOUT PRIOR PERMISSION FROM WATER RESOURCES DEPARTMENT.
8. THE PROMOTER SHOULD PROVIDE NECESSARY RAIN WATER HARVESTING ARRANGEMENTS IN THE SITE AT HIS OWN COST.
9. SEPARATE SEWAGE TREATMENT PLANT & RECYCLING PLANT SHOULD BE PROVIDED IN THE PROPOSED SITE AT PROMOTER'S OWN COST FOR HIS USE. SO, THE SEWAGE WATER OF THE PROPOSED SITE SHOULD NOT BE LET IN TO THE CHANNEL AT ANY COST.
10. THE ANY ENCROACHMENT IN THE CHANNEL PORAMBROKE BY THE PROMOTER WILL BE TREATED AS UNLAWFUL AND WILL BE EVICTED BY THE GOVERNMENT.
11. THE WATER RESOURCES DEPARTMENT OFFICIALS SHOULD BE ALLOWED TO INSPECT THE SITE AT ANY TIME DURING EXECUTION.
12. THE PROMOTER SHOULD PAY AN ANNUAL TRACK RENT OF RS. 13000/- PER ANNUM IN THE FORM OF DEMAND DRAFT DRAWN IN FAVOUR OF THE "THE EXECUTE ENGINEER, P.W.D., KOSSTHILADYAR BASIN DIVION, "THIRUVALLUR", IF CULVERT IS PROPOSED TO CONSTRUCT. THE SERVICE BANK MAY BE AT THIRUVALLUR FOR ENCASHMENT THE DEMAND DRAFT AMOUNT.
13. THE TRACK RENT SHOULD BE PAID IN ADVANCE TO THE ENGINEER, P.W.D., KOSSTHILADYAR BASIN DIVION, "THIRUVALLUR".
14. THE TRACK RENT SHOULD BE PAID IN ADVANCE TO THE ENGINEER, P.W.D., KOSSTHILADYAR BASIN DIVION, "THIRUVALLUR".
15. THE PROMOTER SHOULD BE IN AGREEMENT WITH THE EXECUTIVE ENGINEER, WATER RESOURCES DEPARTMENT, KOSSTHILADYAR BASIN DIVISION, THIRUVALLUR FOR TRACK RENT.
16. THE PROMOTER SHOULD ABIDE BY RULES AND REGULATIONS OF THE WATER RESOURCES DEPARTMENT ISSUED FROM TIME TO TIME.
17. THE PERMISSION GRANTED IS LIABLE TO BE REVOKED, IF BREACH ANY OF THE CONDITIONS NOTICED AND IN THE EVENT OF SUCH REVOCATION, THE PROMOTER SHALL NOT BE ELIGIBLE TO ANY COMPENSATION WHATSOEVER.

CONDITIONS:

THE LAYOUT APPROVED IS VALID SUBJECT TO OBTAINING SANCTION FROM THE LOCAL BODY CONCERNED.

P.P.D NO: 33
L.O APPROVED 2010

VIDE LETTER NO : LI / 8362 / 2010
 DATE : 30 / 10 / 2010

OFFICE COPY

FOR MEMBER SECRETARY
 CHENNAI METROPOLITAN
 DEVELOPMENT AUTHORITY

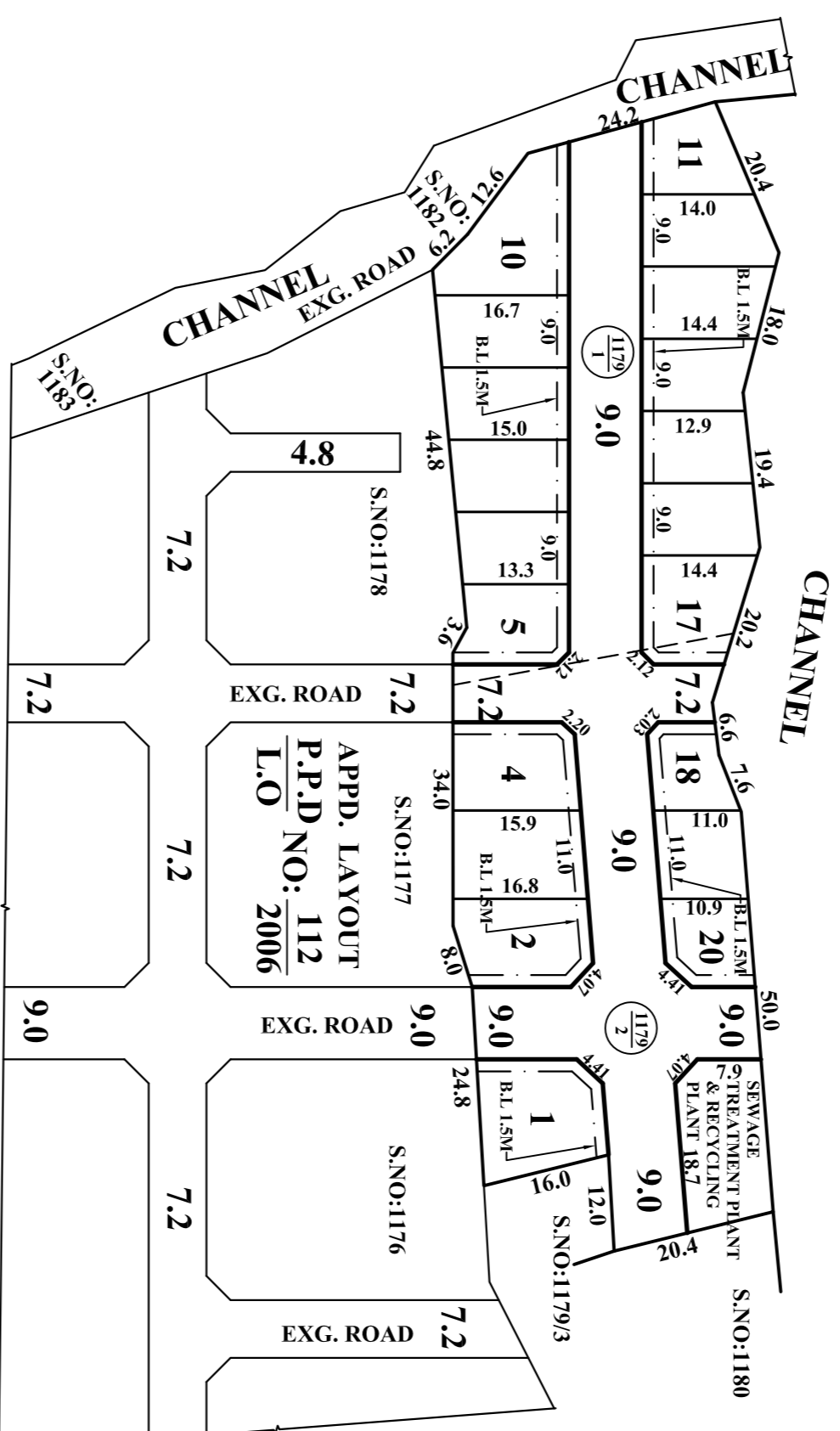
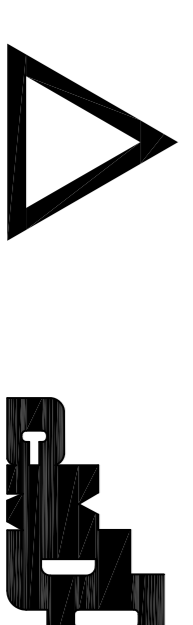

S.NO:1181

KUNDRATHUR TOWN PANCHAYAT

LAYOUT OF HOUSE SITES IN S.NO: 1179/1 AND 1179/2 OF KUNDRATHUR VILLAGE.

SCALE: 1:800 (ALL MEASUREMENTS ARE IN METRE.)

- LEGEND:**
- ▬ SITE BOUNDARY
 - ▬ PROPOSED ROAD
 - ▬ EXISTING ROAD