

TOTAL EXTENT : 12221 M²
 ROAD AREA : 3467 M²
 PARK AREA : 922 M²
 PUBLIC PURPOSE PLOTS (I TO IV) : 956 M²
 TOTAL No. OF PLOTS : 51 Nos.
 REGULAR PLOTS (1 TO 33) : 33 Nos.
 E.W.S PLOTS (34 TO 51) (938 M²): 18 Nos.

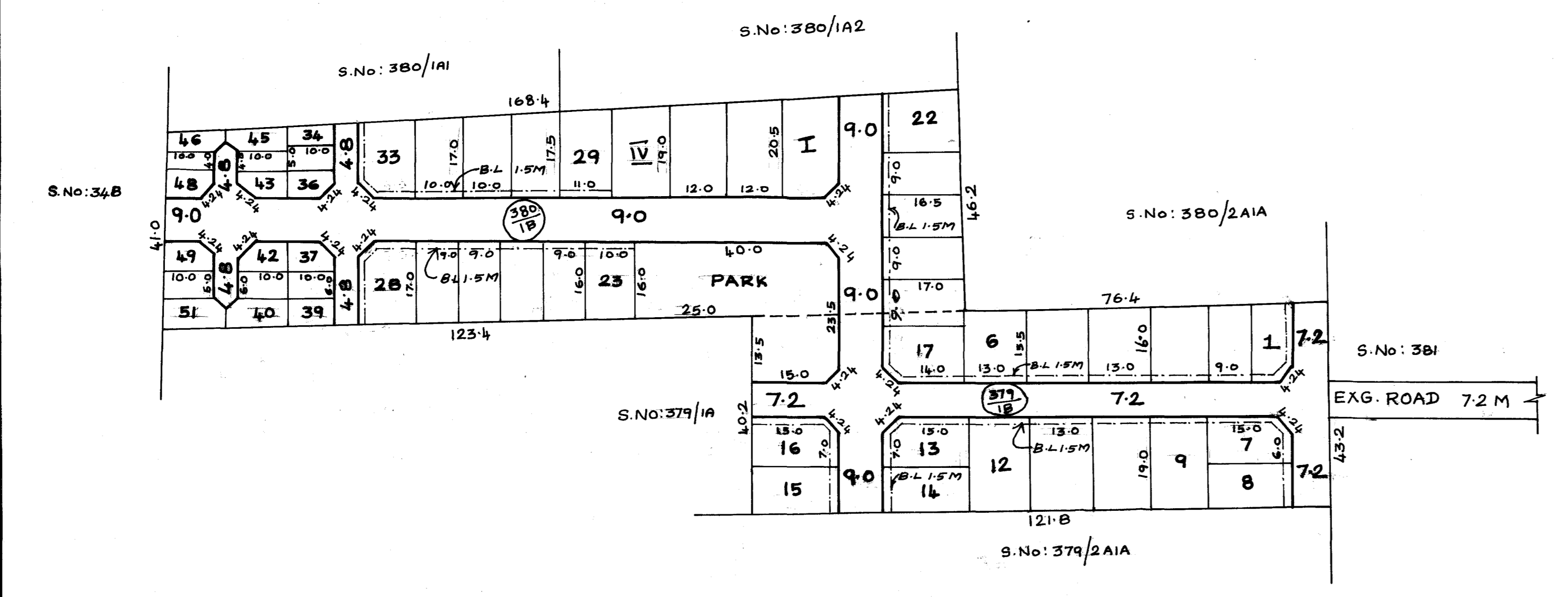

NOTE :-

1. SPLAY 3.0M X 3.0M.
2. MEASUREMENTS INDICATED ARE EXCLUDING THE SPLAY DIMENSIONS.
3. ROAD AREA WERE ALREADY HANDED OVER TO THE LOCAL BODY
 PARK AREA VIDE GIFT DEED No: 551/2010 DT: 11.02.2010

CONDITION :-

THE AREA EARMARKED FOR PUBLIC PURPOSE PLOTS I TO IV (VIZ. POST AND TELEGRAPH OFFICE, POLICE STATION ETC. WOULD REMAIN RESERVED FOR A SPECIFIC PERIOD OF ONE YEAR FROM THE DATE OF APPROVAL TO ENABLE THE GOVERNMENT DEPT. CONCERNED TO NEGOTIATE WITH THE OWNER AND ACQUIRE THE RESERVED LAND IF REQUIRED FOR THEM. THE COST OF THE PLOT SHOULD NOT BE MORE THAN GUIDE LINE VALUE. IF THE PROMOTER ADDS PROPORTIONATE DEVELOPMENT COST ON THE PRICE OF THE PUBLIC PURPOSE PLOT, THE SAME SHOULD BE APPROVED BY CMDA. AFTER THE SAID PERIOD OF ONE YEAR AND IF NONE OF THE AGENCIES PURCHASE THE RESERVED LAND FULL/PART, THE LAYOUT OWNER/DEVELOPER IS FREE TO DISPOSE OF THE SITE RESERVED FOR PUBLIC PURPOSE TO ANY BODY FOR RESIDENTIAL USE ONLY.

CONDITION :-
 THE LAYOUT APPROVED IS VALID SUBJECT TO OBTAINING SANCTION FROM THE LOCAL BODY CONCERNED.

LEGEND :-

- SITE BOUNDARY
- PROPOSED ROAD
- EXISTING ROAD
- PARK
- PUBLIC PURPOSE PLOTS
- EWS

P.P.D NO. 21
 L.O APPROVED 2010
 VIDE LETTER No: LI/3408/2010
 DATE : 30/06/2010

FOR MEMBER SECRETARY
 CHENNAI METROPOLITAN
 DEVELOPMENT AUTHORITY

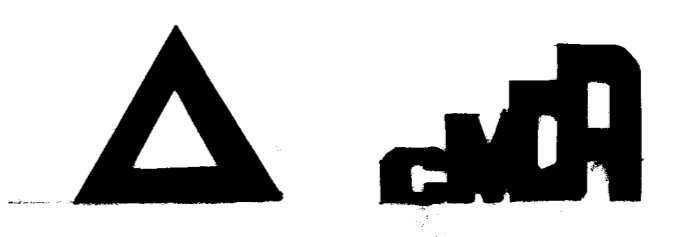

PERUNGALATHUR TOWN PANCHAYAT
 LAYOUT OF HOUSE SITES IN S.No: 379/1B AND 380/1B OF
 PERUNGALATHUR VILLAGE.
 SCALE : 1:800 (ALL MEASUREMENTS ARE IN METRE)

REMARKS

REMARKS