

TOTAL EXTENT : 6890 M<sup>2</sup>  
 ROAD AREA : 1589 M<sup>2</sup>  
 PARK AREA : 273 M<sup>2</sup>  
 NO. OF PLOTS : 28 NOS.

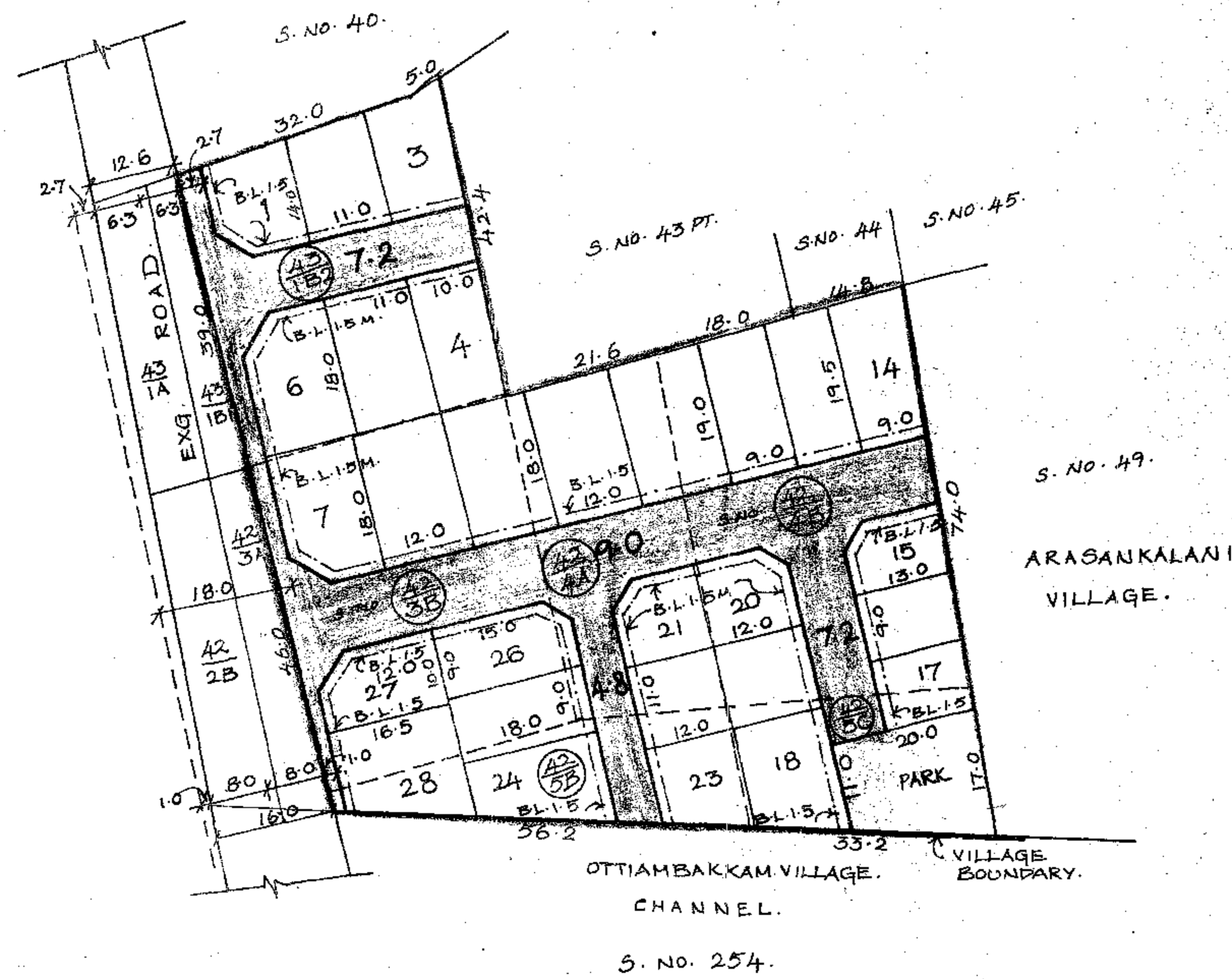

NOTE :

1. SPLAY - 3.0 M X 3.0 M.
2. MEASUREMENTS ARE INDICATED EXCLUDING SPLAY DIMENSIONS.
3. ROAD AREA } WERE ALREADY HANDED OVER TO THE LOCALBODY  
 PARK AREA } VIDE GIFT DEED DOCUMENT NO : 3325/2009. DL. 29.5.09.

CONDITION :

- THE FOLLOWING CONDITIONS OF CHIEF ENGINEER, PWD, WRD, CHENNAI REGION, VIDE LETTER NO : TS (C) 9114/2006, DL. 6.2.06 ARE TO BE COMPLIED BY THE APPLICANT BEFORE FORMATION OF THE LAYOUT.
1. THE GROUND LEVEL OF THE SITE SHOULD BE RAISED TO (G) 10.595 M WITH AN AVERAGE FILLING OF 100 M OVER THE ENTIRE AREA OF THE SITE.
  2. THERE SHOULD NOT BE ANY HINDERENCE TO THE FREE FLOW OF WATER IN THE FIELD CHANNEL TO THE LOWER DOWN AYACUT.
  3. TO AVOID ENCROACHMENT ACTIVITIES, PERMANENT COMPOUND WALL SHOULD BE CONSTRUCTED ON THE SOUTHERN BOUNDARY AFTER MARKING OF THE BOUNDARY BY THE REVENUE DEPT. IN THE PRESENCE OF THE PWD OFFICIAL.
  4. THE PROMOTER SHOULD ABIDE BY THE RULES AND REGULATIONS OF THE PWD ISSUED FROM TIME TO TIME.
  5. FAILING TO COMPLY WITH ANY OF THE ABOVE CONDITIONS, THE PWD RESERVES THE RIGHTS TO WITH DRAW THE NO OBJECTION CERTIFICATE ISSUED.

LEGEND

- SITE BOUNDARY
- PROPOSED ROAD
- EXISTING ROAD
- PARK
- CHANNEL

CONDITION

THE LAYOUT APPROVAL IS VALID SUBJECT TO OBTAINING SANCTION FROM THE LOCALBODY CONCERNED.

P.P.D NO. 42  
 L.O 2009.

APPROVED. IC

VIDE LETTER NO : L1/10019/09.

DATED : 6/10/2009

OFFICE COPY

8.10.09

FOR MEMBER - SECRETARY  
 CHENNAI METROPOLITAN  
 DEVELOPMENT AUTHORITY.



# ST. THOMAS MOUNT PANCHAYAT UNION

LAYOUT OF HOUSE SITES IN S.NOS. 42/3B, 4A, 4B, 5B, 5C AND

43/1B2 OF ARASANKALANI VILLAGE.

SCALE - 1:800. (ALL MEASUREMENTS ARE IN METRE)