

TOTAL EXTENT
 AS PER PATTAS : 1400 M²
 AS PER DOCUMENT : 1244.9 M²
 SPLAY AREA : 9.0 M²
 NO. OF PLOTS : 3 NOS.

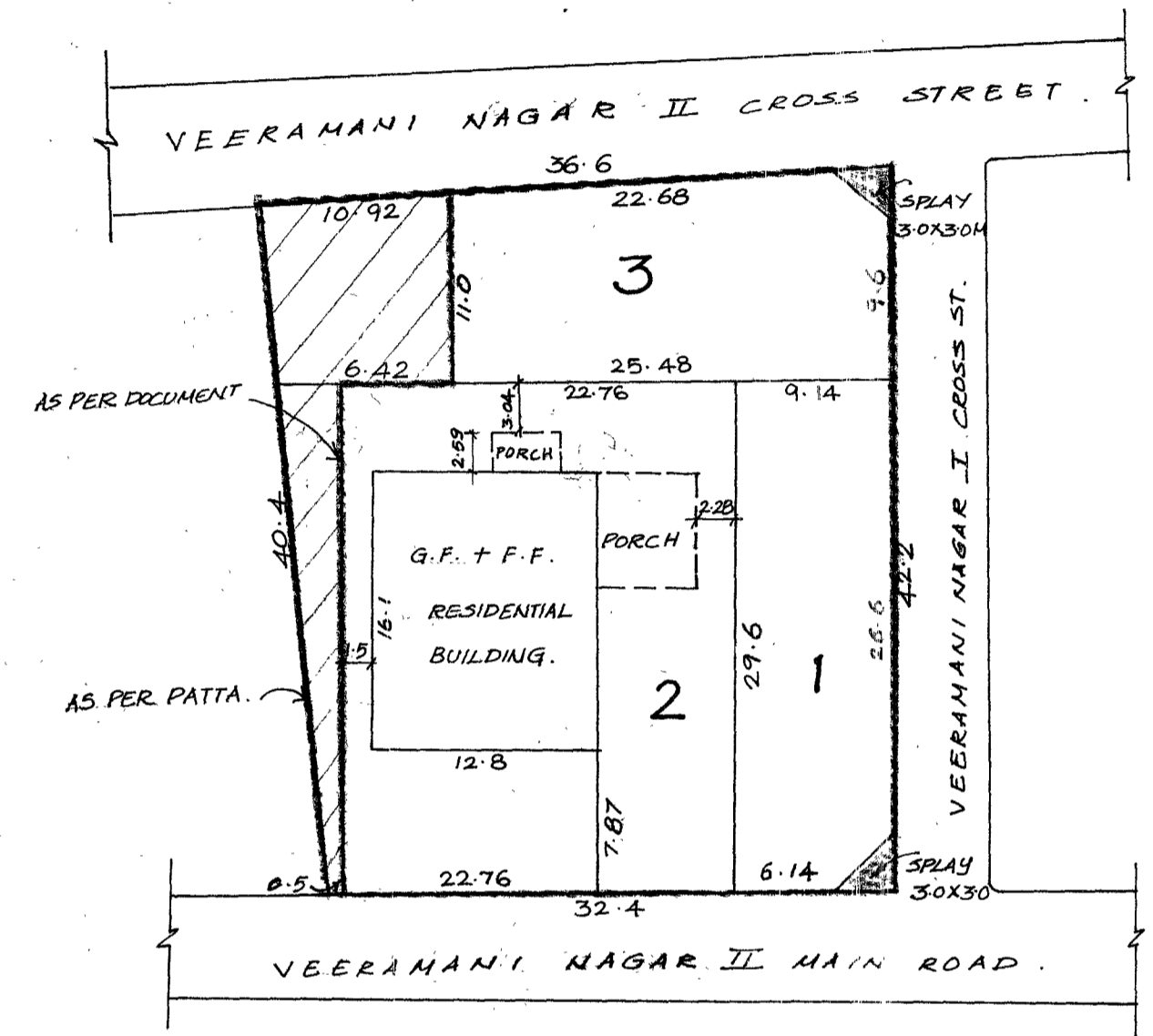

LEGEND :

- SITE BOUNDARY AS PER PATTAS
- SITE BOUNDARY AS PER DOCUMENT.
- SPLAY
- EXISTING ROAD.

ST. THOMAS MOUNT PANCHAYAT UNION.
 PROPOSED CONVERSION & SUBDIVISION OF SCHOOL SITE IN
 THE APPROVED LAYOUT NO. LPDM / DTP NO. 66/72 IN TO
 RESIDENTIAL PLOTS IN S.NO. 210/2A2 OF NANMANGALAM VILLAGE
 SCALE : 1 : 400. (ALL MEASUREMENTS ARE IN METRE)

P.P.D NO. 1
 2009
 L.L.O APPROVED.
 VIDE LETTER NO: L1/12803/07.
 DATED : 09/01/2009.
 OFFICE COPY IC
 FOR MEMBER SECRETARY
 CHENNAI METROPOLITAN
 DEVELOPMENT AUTHORITY.

