

TOTAL EXTENT : 1335 m<sup>2</sup>  
 ROAD AREA : 247 m<sup>2</sup>  
 NO. OF PLOTS : 6 nos.

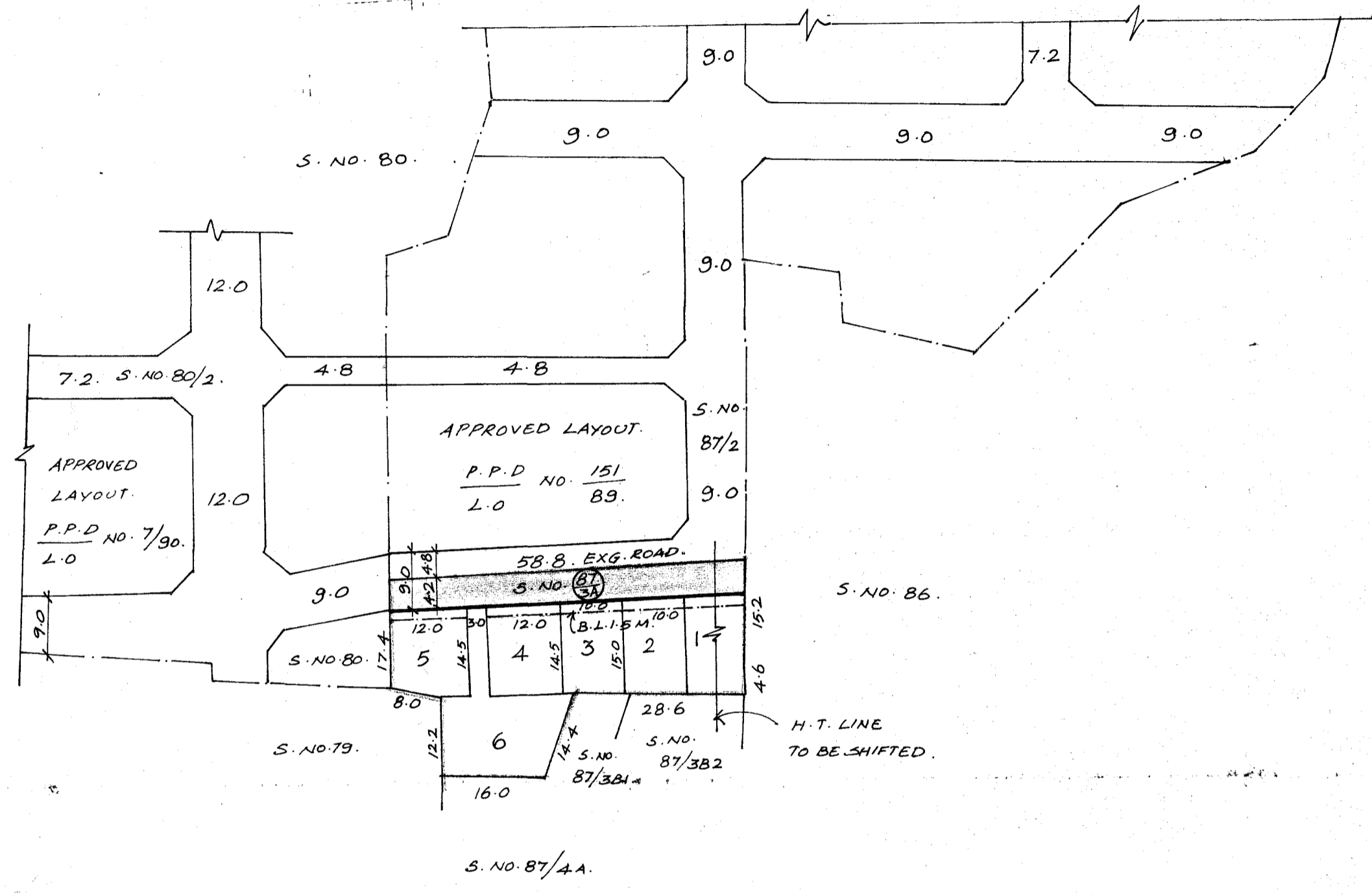

NOTE :  
 ROAD AREA WAS ALREADY HANDED OVER TO THE LOCAL BODY, VIDE GIFT DEED IN DOCUMENT NO: 8364/2008. DATED. 12.08.2008.

CONDITION :  
 DR RULE NO : 29 (11)  
 THE COST OF LAYING / IMPROVEMENTS TO THE SYSTEMS IN RESPECT OF ROAD, WATERSUPPLY, SEWERAGE, DRAINAGE OR ELECTRIC POWER SUPPLY THAT MAY BE REQUIRED AS ASSESSED BY THE COMPETENT AUTHORITY, SHALL BE BORNE BY THE APPLICANT.

LEGEND :  
 [Symbol] SITE BOUNDARY  
 [Symbol] PROPOSED ROAD  
 [Symbol] EXISTING ROAD.

P.P.D NO. 28  
 L.O 2008.  
 APPROVED. IC  
 VIDE LETTER NO : LI / 15069 / 08.  
 DATED : 26 / 11 / 2008.  
 OFFICE COPY  
 FOR MEMBER SECRETARY  
 CHENNAI METROPOLITAN  
 DEVELOPMENT AUTHORITY.

# POONAMALLEE PANCHAYAT UNION.

PROPOSED SUBDIVISION OF HOUSE SITES IN S. NO. 87/3A OF NEMILICHERI VILLAGE.

SCALE - 1 : 800. (ALL MEASUREMENTS ARE IN METRE)

