

TOTAL EXTENT (2.25AC) : 9105M<sup>2</sup>  
 ROAD AREA : 1896M<sup>2</sup>  
 NO. OF PLOTS : 39 (1 TO 39)

**NOTE:**

1. SPLAY 3.0M X 3.0M
2. MEASUREMENTS INDICATED ARE EXCLUDING SPLAY DIMENSIONS
3. ROAD AREA WAS ALREADY HANDED OVER TO THE LOCAL BODY  
 VIDE GIFT DEED DOC. NO. 14715/06, DATED 29/12/06

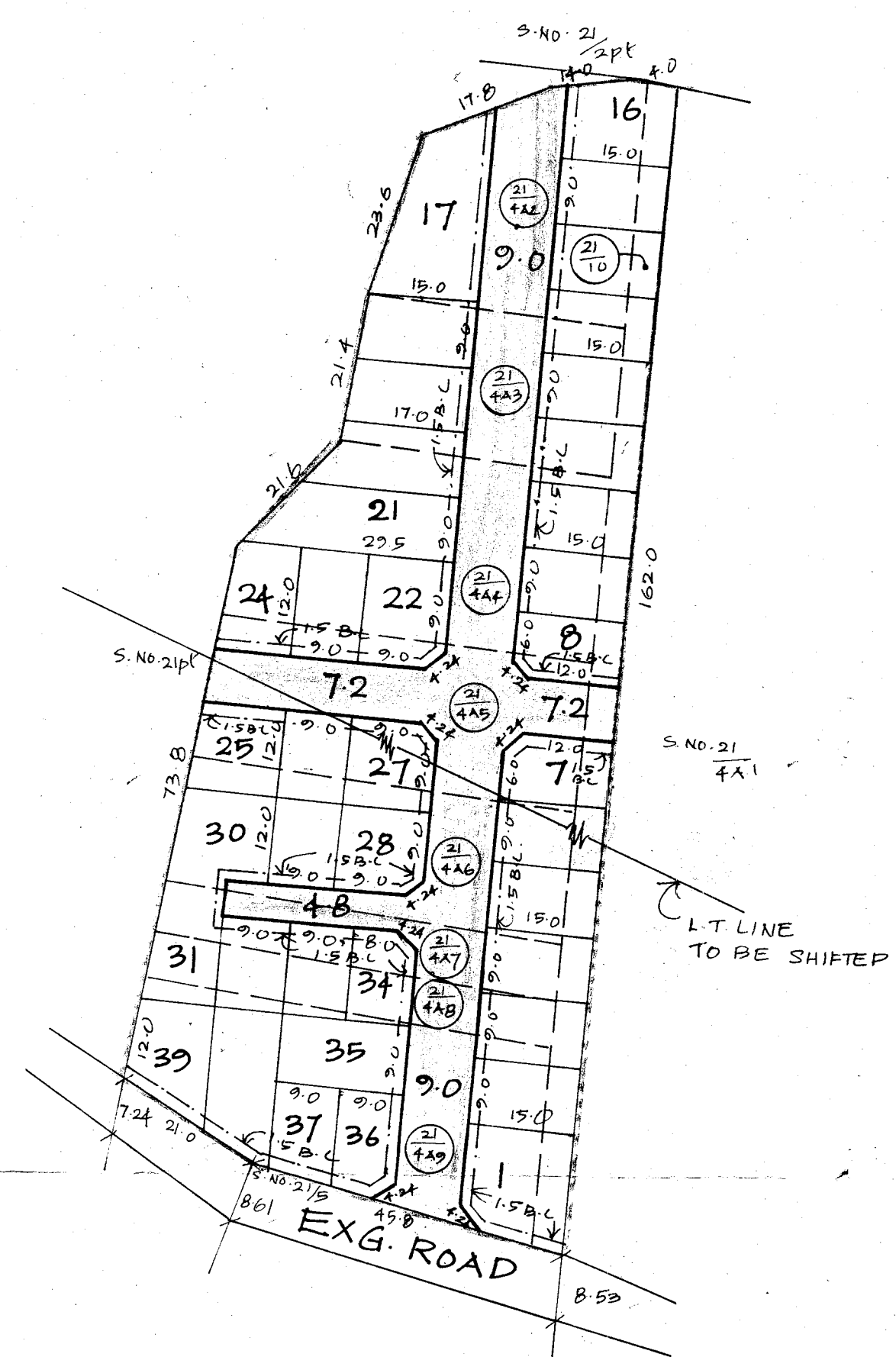

**LEGEND:**

- SITE BOUNDARY
- EXISTING ROAD
- PROPOSED ROAD

P.P.D. NO. 29  
 L.O. APPROVED 2007  
 VIDE LETTER NO. : L/3912/07  
 DATED : 29-3-07

**OFFICE COPY**

FOR MEMBER-SECRETARY  
 CHENNAI METROPOLITAN  
 DEVELOPMENT AUTHORITY

**THIRUVERKADU MUNICIPALITY**  
 LAYOUT OF HOUSE SITES IN S.NO. 21/4A2, 4A3, 4A4, 4A5, 4A6,  
 21/4A7, 4A8, 4A9 & 21/10 OF NOOMBAL VILLAGE.  
 SCALE : 1:800

