

101

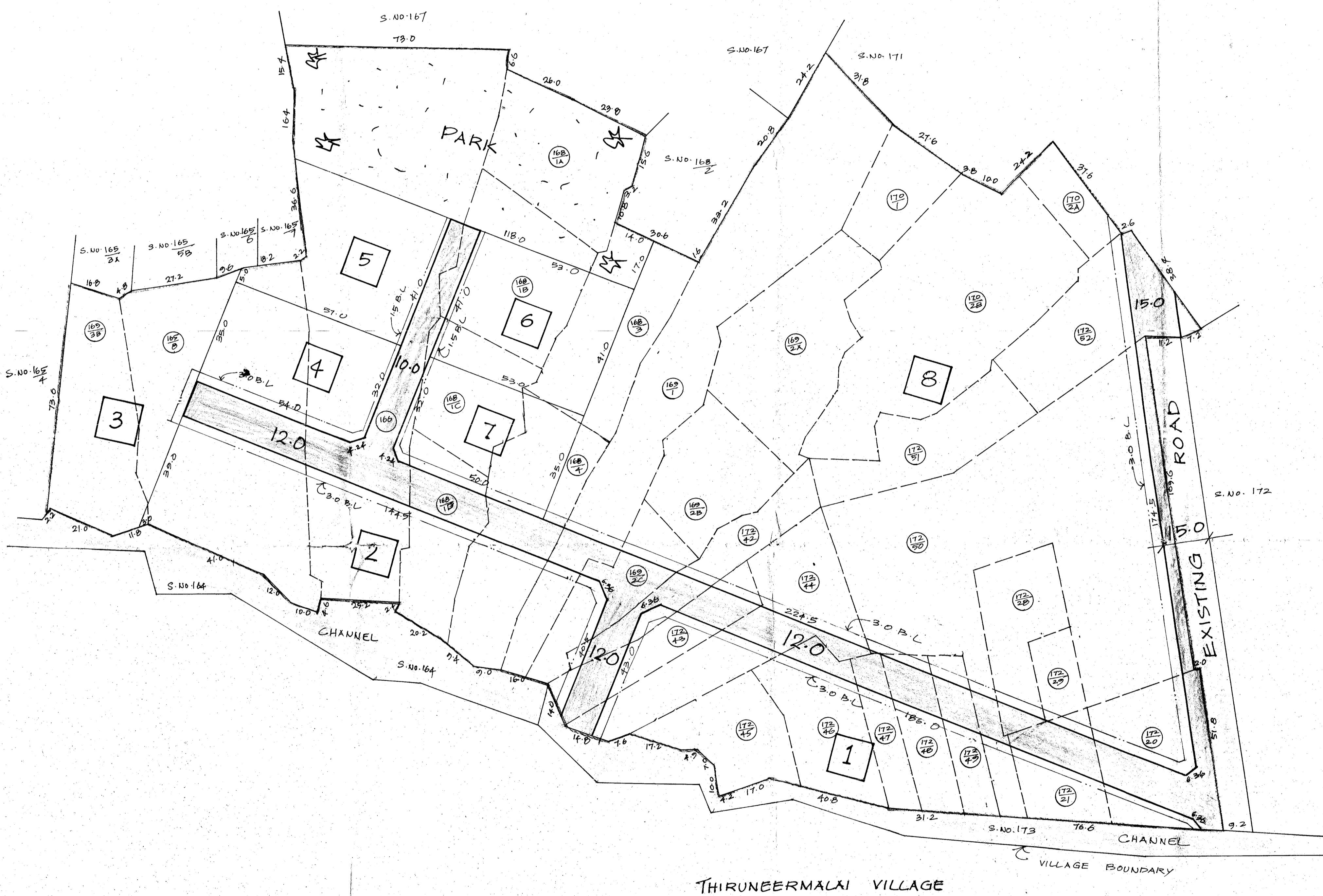

TOTAL EXTENT : 62600M<sup>2</sup>  
 ROAD AREA : 6780M<sup>2</sup>  
 PARK AREA : 5620M<sup>2</sup>  
 NO OF PLOTS : 8 (1 TO 8)

**NOTE:**  
 1. SPLAY 3.0M X 3.0M.  
 2. MEASUREMENTS INDICATED ARE EXCLUDING SPLAY DIMENSIONS  
 3. ROAD AREA WERE ALREADY HANDED OVER TO THE LOCALBODY  
 PARK AREA VIDE GIFT DEED DOC. NO. 2321/2006 DATED 10/6/2006

**LEGEND**  
 [---] SITE BOUNDARY  
 [---] EXISTING ROAD  
 [---] PROPOSED ROAD  
 [---] PARK

PAMMAL MUNICIPALITY

SUB-DIVISION OF HOUSE SITES IN S.NO. 165/3A, B, 166, 168/1A, 1B, 1C, 1D, 3, 4, 169/1, 2A, 2B, 2C, 170/1, 2A, 2B, 172/20, 21, 28, 29, 42, 43, 44, 45, 46, 47, 48, 49, 50, 51 & 172/52 OF PAMMAL VILLAGE

SCALE: 1:800

P.P.D NO. 87  
 L.O 2006  
 APPROVED  
 VIDE LETTER NO : L/10222/06  
 DATED : 31/8/06  
 o/c  
 FOR MEMBER SECRETARY  
 CHENNAI METROPOLITAN  
 DEVELOPMENT AUTHORITY

