

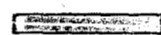
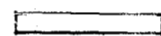

TOTAL EXTENT : 7700 M²
 ROAD AREA : 2557 M²
 NO. OF PLOTS : 37

NOTE

1. SPLAY 3.0 X 3.0 M
2. MEASUREMENTS INDICATED ARE EXCLUDING SPLAY DIMENSIONS
3. ROAD AREA WAS ALREADY HANDED OVER TO THE LOCAL BODY VIDE GIFT DEED DOC NO. 7176/05 AND RECTIFICATION DEED DOC. NO. 9480/05 DATED : 22/11/05

LEGEND

-  SITE BOUNDARY
-  EXISTING ROAD
-  PROPOSED ROAD

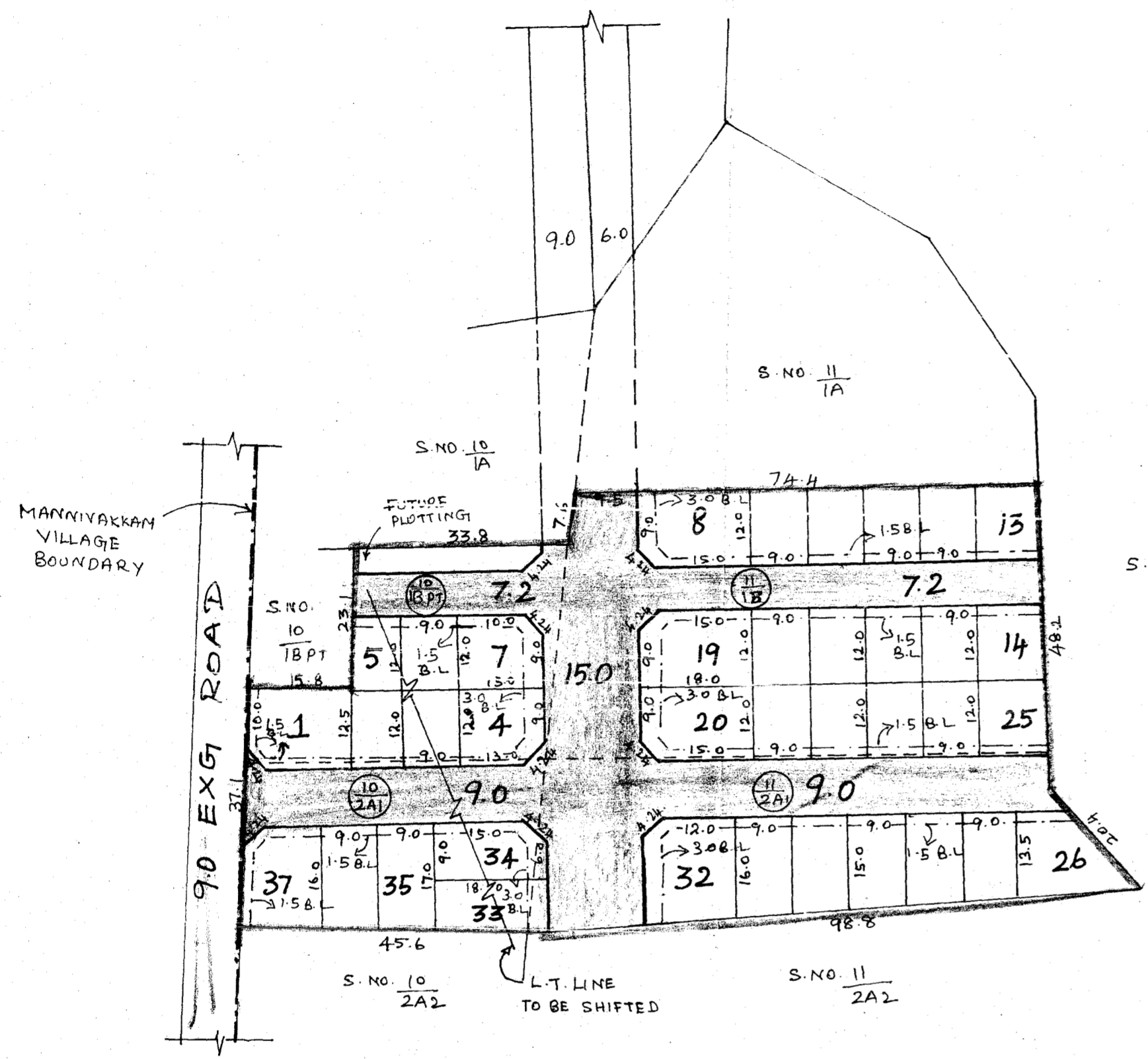

P.P.D NO. 115
 L.O NO. 2005
 APPROVED *I.C.*
 VIDE LETTER NO : LI/25927/05
 DATED : 16/12/05

OFFICE COPY

FOR MEMBER - SECRETARY
 CHENNAI METROPOLITAN
 DEVELOPMENT AUTHORITY

KATTANKULATHUR PANCHAYAT UNION
 LAYOUT OF HOUSE SITES IN S.NO.10/1BPT,2A1,11/1B,2A1 OF VANDALUR VILLAGE

SCALE : 1 : 800

