

11/30/2004

TOTAL EXTENT : 2950m²
 ROAD AREA : 657m²
 N^o OF PLOTS : 14

NOTE:

1. SPLAY 3.0M X 3.0M
2. MEASUREMENTS INDICATED ARE EXCLUDING SPLAY DIMENSIONS
3. ROAD AREA WAS ALREADY HANDED OVER TO THE LOCAL BODY VIDE GIFT DEED DOC. NO. 4329/2004 DATED. 20.8.2004

LEGEND

- [Solid line] SITE BOUNDARY
- [Dashed line] EXISTING ROAD
- [Double line] PROPOSED ROAD

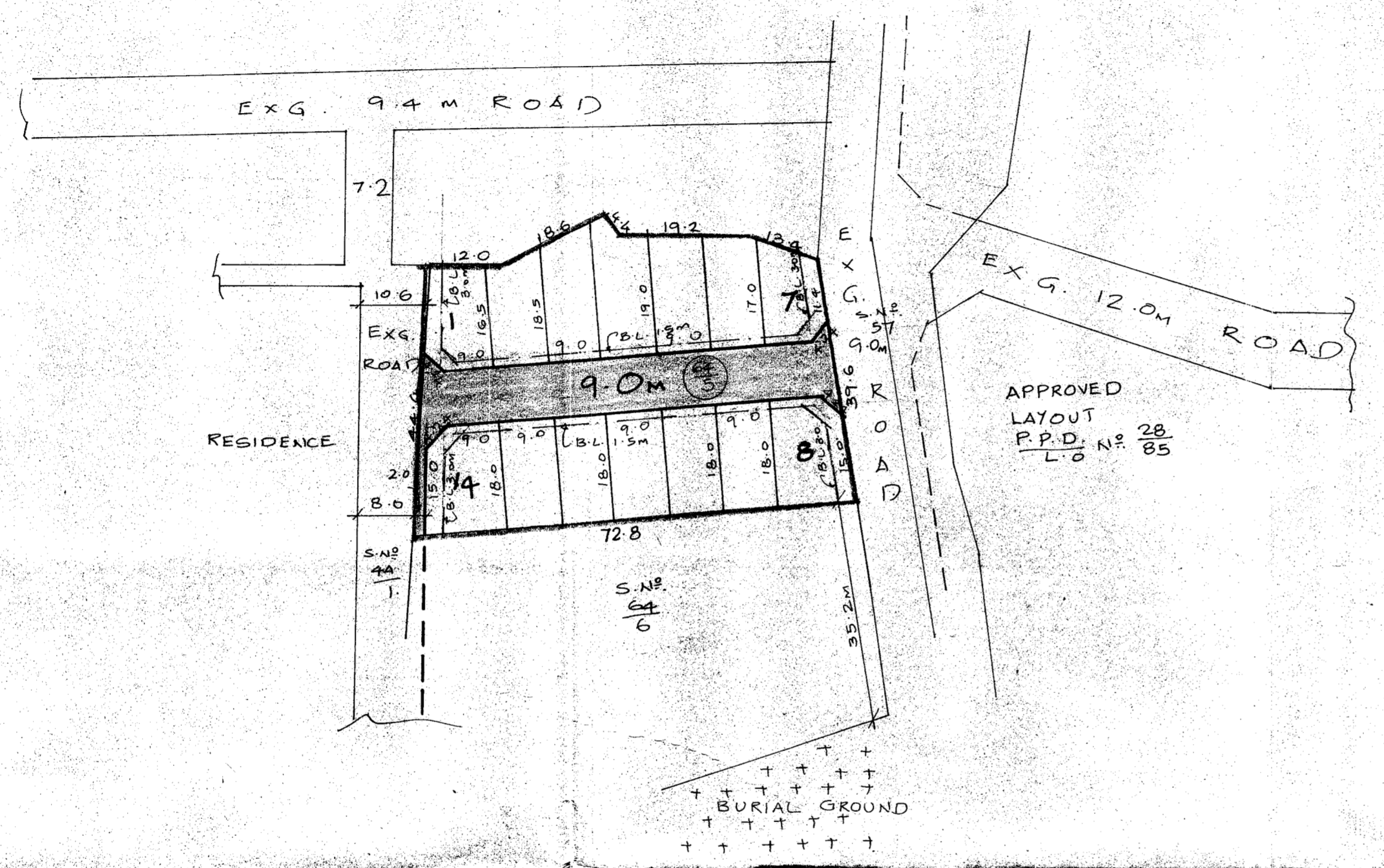

THIRUNINDRAVUR TOWN PANCHAYAT

LAYOUT OF HOUSE SITES IN S.N.º 64/5 OF

THIRUNINDRAVUR VILLAGE

SCALE: 1:800

P.P.D N.º 108 (118)
 L.O N.º 2004

APPROVED

VIDE LETTER N.º LI/36650/03
 DATED 9-07-2004

OFFICE COPY

FOR MEMBER SECRETARY
 CHENNAI METROPOLITAN
 DEVELOPMENT AUTHORITY

