

TOTAL EXTENT : 750 M<sup>2</sup>  
 NO OF PLOTS : 3

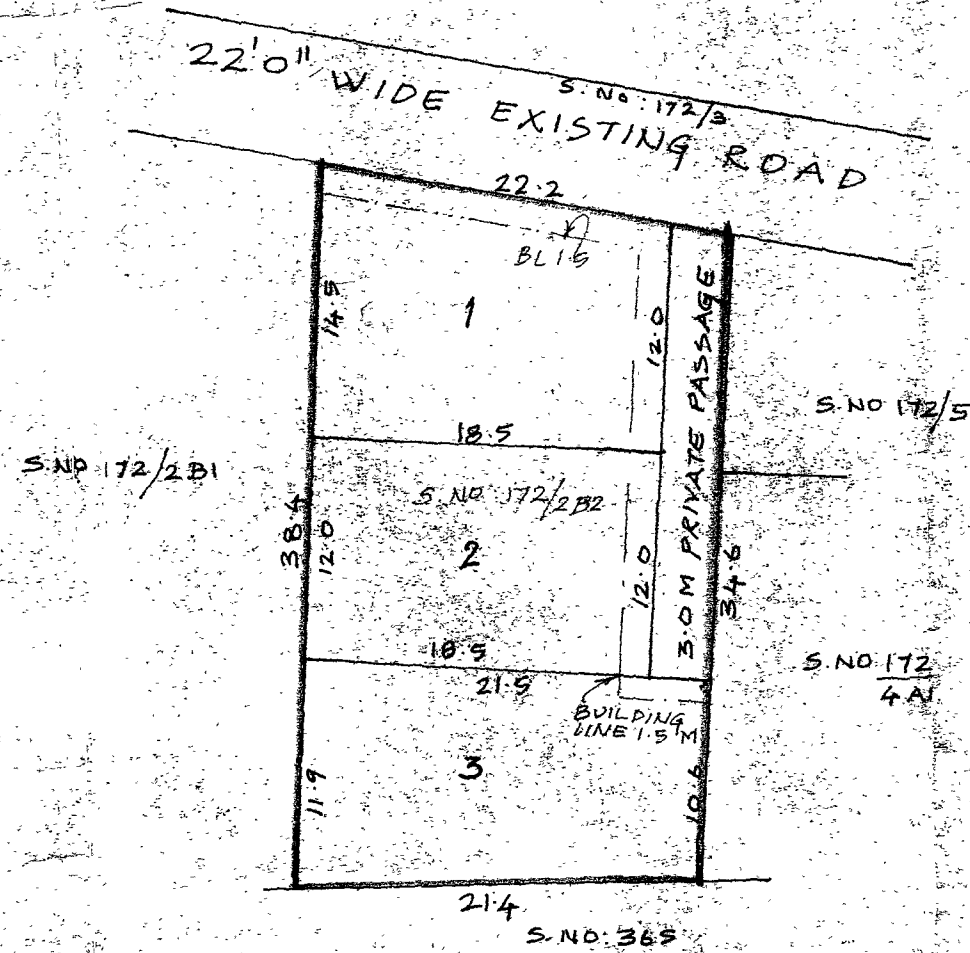

**LEGEND**  
 [Line] SITE BOUNDARY  
 [Line] EXISTING ROAD

P.P.D NO : 119  
 L.O 2003

APPROVED  
 VIDE LETTER NO : L/7126/2003  
 DATED : 4/11/2003

FOR MEMBER SECRETARY  
 CHENNAI METROPOLITAN  
 DEVELOPMENT AUTHORITY.



# PERUNGALATHUR TOWN PANCHAYAT

SUB-DIVISION OF HOUSE SITES IN S.NO:172/2.B2 OF

PERUNGALATHUR VILLAGE.

SCALE : 1:400