

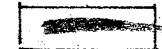
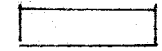

TOTAL EXTENT : 4900 m²
 ROAD AREA : 1139 m²
 NO. OF PLOTS : 22

NOTE :-

1. SPLAY 10' X 10'
2. MEASUREMENTS INDICATED ARE EXCLUDING SPLAY DIMENSION
3. ROAD AREA ALREADY HANDED OVER TO THE LOCAL BODY VIDE GIFT DEED DOC. NO. 1906 DT. 23.8.2001

LEGEND

-  SITE BOUNDARY
-  EXISTING ROADS
-  PROPOSED ROADS

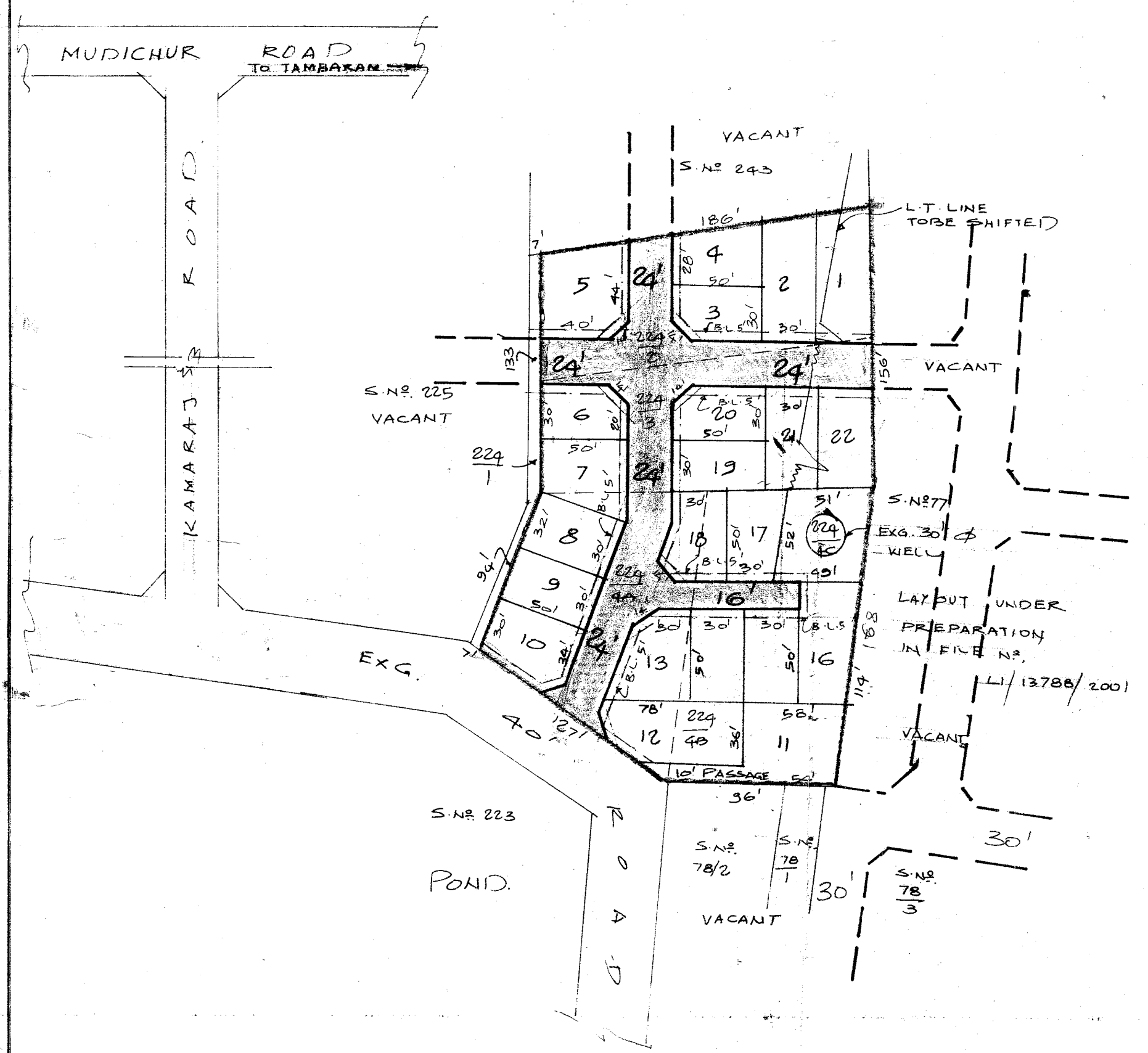

P.P.D No. 62
 L.O No. 2001 (T.D)

APPROVED

VIDE LETTER NO. : LI/20549/2001
 DATED : 3.2001

FOR MEMBER SECRETARY
 CHENNAI METROPOLITAN
 DEVELOPMENT AUTHORITY



PERUNGALATHUR TOWN PANCHAYAT
 LAYOUT OF HOUSE SITES IN S.No 224/2, 224/3, 224/4A & 224/4B
 OF PERUNGULATHUR VILLAGE

SCALE : 66 FEET TO AN INCH